

I-block Type

* Features

- It is easy to install to the outside of the vehicle because of the cast body.
- Various applications are available by port changing.

- Durable to heavy shock.

- It is suitable for a mid flow system and small equipments.

Dimensions

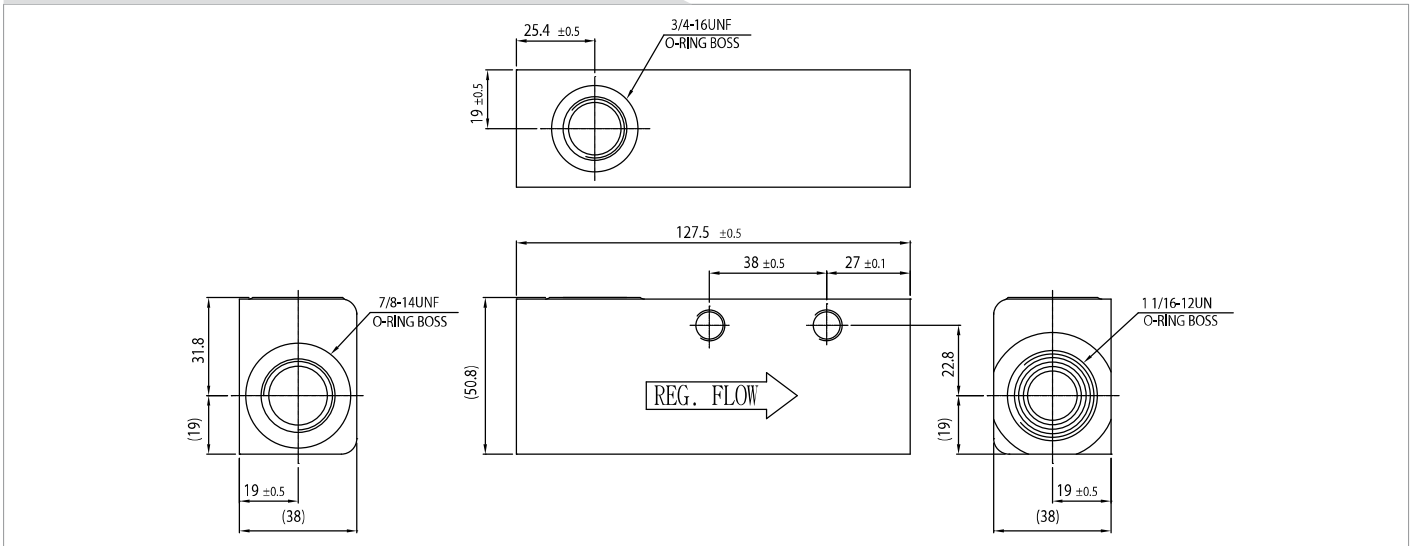

SINJIN PRECISION CO., LTD.

Bypass Valve



Keeping constant pressure within the requested flow limit, the Bypass Valve can protect the hydraulic system against the path blocking. The valve does

a similar functioning with the relief valves, but it controls larger flow at lower pressure to re-direct the flow path.

