

Gear Motor



Introduction

Fixed displacement motor GM are reversible external gear motors

These compact motors can be used for fan drive system in vehicles and machines

Features

- Integrated outboard bearings for heavy duty applications
- The wide choice of shafts, flanges and ports
- High efficiency
- Built in valve: pressure relief valve, reverse valves, anti-cavitation valve(for fan drives)

Specifications

- Max.peak pressure: 250bar
- Case drain pressure: 2bar
- Table(theoretical values)

size	units	GM 19	GM 31
Displacement	cm ³	19	31
Max. pressure	bar	210	210
Speed	rpm	3500	3000

Dimensions(GM 19)

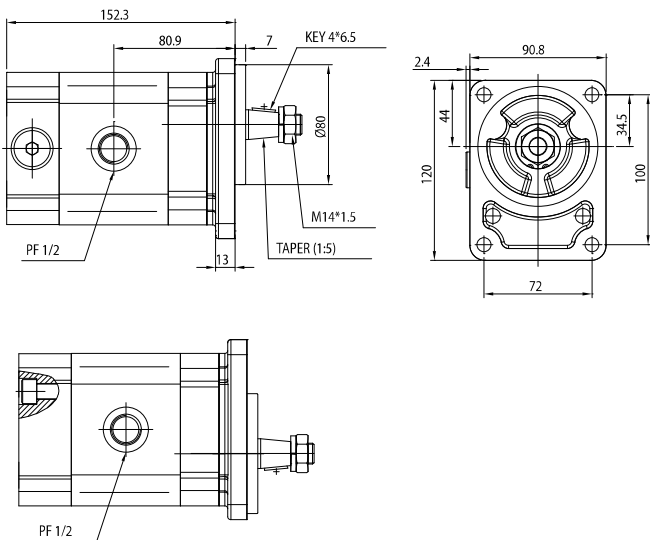

Dimensions(GM 31)

